

11" STANDARD

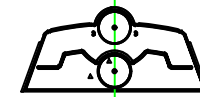

14"/16" HIGH CAPACITY

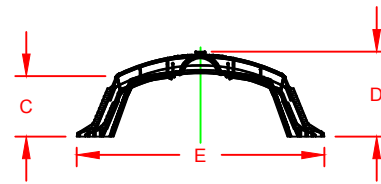
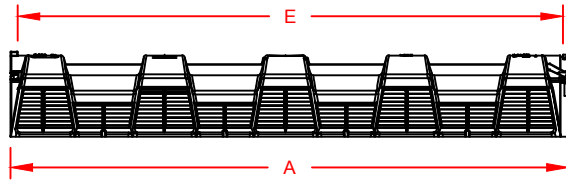
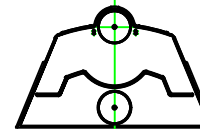
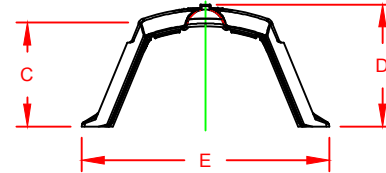
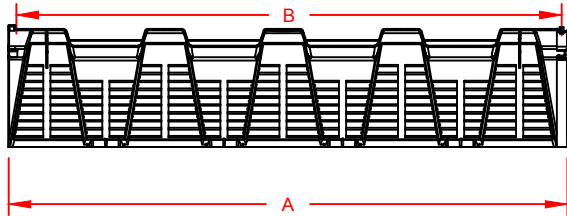

BIO 2

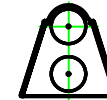
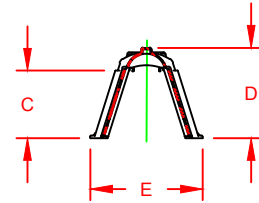
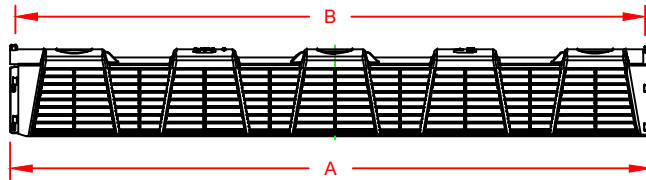

BIO 3

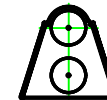
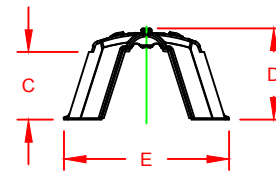
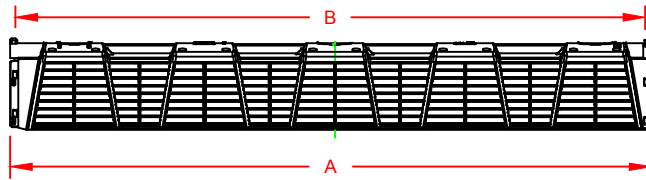

MODEL	11" STND	14 HICAP	16" HICAP	BIO 2	BIO 3
LENGTH (A)	76" (1930mm)	76" (1930mm)	76" (1930mm)	87" (2210mm)	87" (2210mm)
EFFECTIVE LENGTH (B)	75" (1905mm)	75" (1905mm)	75" (1905mm)	86" (2184mm)	86" (2184mm)
SIDEWALL HEIGHT (C)	6.4" (163mm)	9.7" (246mm)	11.2" (284mm)	9.0" (229mm)	9.0" (229mm)
OVERALL HEIGHT (D)	11" (279mm)	14" (356mm)	16" (406mm)	12" (305mm)	12" (305mm)
OVERALL WIDTH (E)	34" (864mm)	34" (864mm)	34" (864mm)	15" (381mm)	22" (559mm)
CAPACITY	9.2 CF (68.8 GAL)	11.91 CF (89.0 GAL)	13.6 CF (101.7 GAL)	5.0 CF (37.4 GAL)	8.5 CF (63.6 GAL)

NOTE:

UNIT CONFIGURATION AND AVAILABILITY SUBJECT TO CHANGE WITHOUT NOTICE. PRODUCT DETAIL MAY DIFFER SLIGHTLY FROM ACTUAL PRODUCT APPEARANCE.

1	FORMATTING UPDATES AND RENUMBERED	TJR	03/18/16	
REV.	DESCRIPTION	BY	MM/DD/YY	CHK'D

© 2016 ADS, INC.

ADVANCED DRAINAGE SYSTEMS, INC. ("ADS") HAS PREPARED THIS DETAIL BASED ON INFORMATION PROVIDED TO ADS. THIS DRAWING IS INTENDED TO DEPICT THE COMPONENTS AS REQUESTED. ADS HAS NOT PERFORMED ANY ENGINEERING OR DESIGN SERVICES FOR THIS PROJECT, NOR HAS ADS INDEPENDENTLY VERIFIED THE INFORMATION SUPPLIED. THE INSTALLATION DETAILS PROVIDED HEREIN ARE GENERAL RECOMMENDATIONS AND ARE NOT SPECIFIC FOR THIS PROJECT. THE DESIGN ENGINEER SHALL REVIEW THESE DETAILS PRIOR TO CONSTRUCTION. IT IS THE DESIGN ENGINEERS RESPONSIBILITY TO ENSURE THE DETAILS PROVIDED HEREIN MEETS OR EXCEEDS THE APPLICABLE NATIONAL, STATE, OR LOCAL REQUIREMENTS AND TO ENSURE THAT THE DETAILS PROVIDED HEREIN ARE ACCEPTABLE FOR THIS PROJECT.

BIODIFFUSER PRODUCT DETAILS	
DRAWING NUMBER:	STD-909A



4640 TRUEMAN BLVD
HILLIARD, OHIO 43026

ADVANCED DRAINAGE SYSTEMS, INC.

DRAWN BY:	CKS
DATE:	6/25/07
SCALE:	NTS
SHEET:	1 OF 1