

# REINFORCEMENT OVER DURASLOT<sup>®</sup> DRAINS GREATER THAN H-20 LOADING

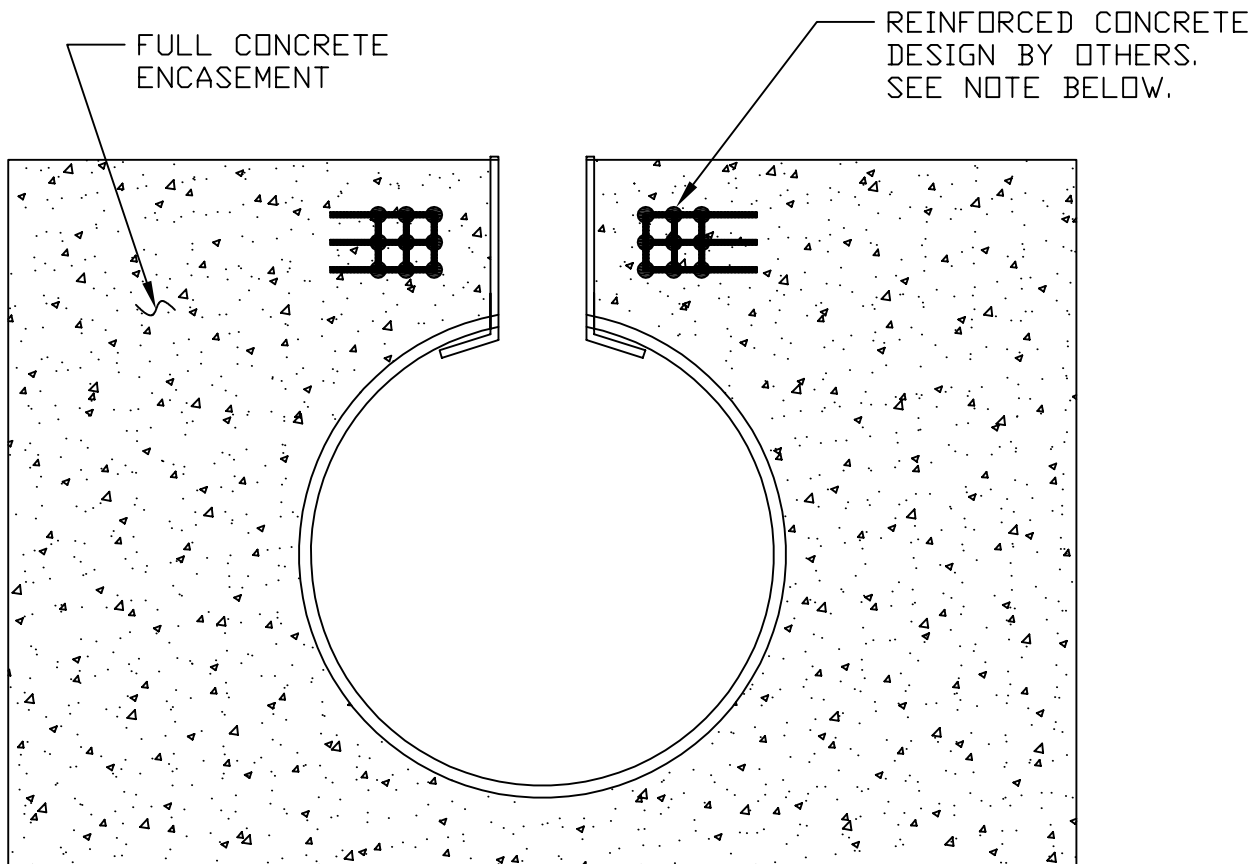

END VIEW

**NOTE:**

**REINFORCING DESIGN INCLUDING NUMBER OF BARS, BAR SPACING AND BAR SIZE MUST BE SUPPLIED BY STRUCTURAL ENGINEER TAKING INTO ACCOUNT DESIGN LOADS, SAFETY FACTORS, CONCRETE STRENGTH AND OTHER RELEVANT PROJECT SPECIFIC CRITERIA. DURASLOT<sup>®</sup> DRAINS ARE NOT A STRUCTURAL COMPONENT.**

				XX DIAMETER FITTING		<b>ADVANCED DRAINAGE SYSTEMS, INC.</b> 4640 TRUEMAN BLVD HILLIARD, OHIO 43026		DRAWN BY: CRM
				<b>REINFORCEMENT FOR DURASLOT GREATER THAN H-20 LOADING</b>				DATE: 10-28-13
1	REINFORCEMENT DEPICTION	CRM	11-13-13					DWD BY:
REV.	DESCRIPTION	BY	MM/DD/YY	CHK'D	DRAWING NUMBER:	CUSTOM		
								SCALE: NTS
								SHEET 1

ADVANCED DRAINAGE SYSTEMS, INC. ("ADS") HAS PREPARED THIS DETAIL BASED ON INFORMATION PROVIDED TO ADS. THIS DRAWING IS INTENDED TO DEPICT THE COMPONENTS AS REQUESTED. ADS HAS NOT PERFORMED ANY ENGINEERING OR DESIGN SERVICES FOR THIS PROJECT, NOR HAS ADS INDEPENDENTLY VERIFIED THE INFORMATION SUPPLIED. THE INSTALLATION DETAILS PROVIDED HEREIN ARE GENERAL RECOMMENDATIONS AND ARE NOT SPECIFIC FOR THIS PROJECT. THE DESIGN ENGINEER SHALL REVIEW THESE DETAILS PRIOR TO CONSTRUCTION. IT IS THE DESIGN ENGINEERS RESPONSIBILITY TO ENSURE THE DETAILS PROVIDED HEREIN MEETS OR EXCEEDS THE APPLICABLE NATIONAL, STATE, OR LOCAL REQUIREMENTS AND TO ENSURE THAT THE DETAILS PROVIDED HEREIN ARE ACCEPTABLE FOR THIS PROJECT.