

# COMPRESSION (CAST-IN) RESILIENT STRUCTURE CONNECTION 12"-30" DUAL WALL HP STORM W/ SLEEVE MH ADAPTER OR NYLOPLAST PVC ADAPTER

COMPRESSION (CAST-IN) RESILIENT  
STRUCTURE CONNECTION  
(A-LOK, ECONOSEAL)

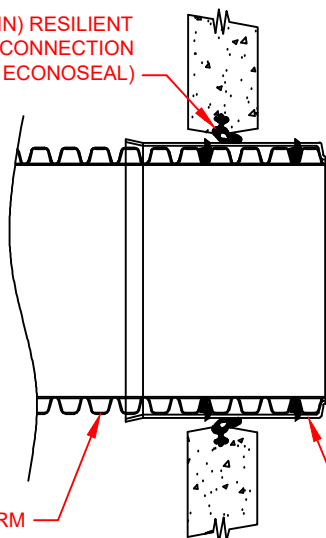

DUAL WALL HP STORM

SLEEVE MH ADAPTER (12" - 24" ONLY)

COMPRESSION (CAST-IN) RESILIENT  
STRUCTURE CONNECTION  
(A-LOK, ECONOSEAL, KWIKSEAL)

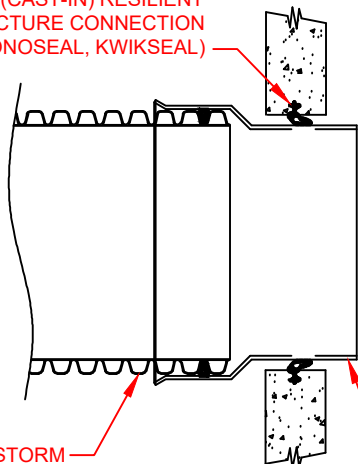

DUAL WALL HP STORM

NYLOPLAST PVC MANHOLE ADAPTER

SANITITE HP SLEEVE MANHOLE ADAPTER

PIPE SIZE	ADS PRODUCT CODES	A-LOK® PREMIUM*	PRESS SEAL® SYSTEMS	
			ECONOSEAL	
12" (300mm)	1222AAPP	490	1250	
15" (375mm)	1522AAPP	580	18300.48500	
18" (450mm)	1822AAPP	710	22000.48500	
24" (600mm)	2422AAPP	915	29000.48500	

\* THIRD PARTY - CODES AS SUPPLIED BY MANUFACTURER  
A-LOK is a registered trademark of A-LOK Products, Inc. (www.a-lok.com)

NYLOPLAST PVC MANHOLE ADAPTER

PIPE SIZE	NYLOPLAST PRODUCT CODES	A-LOK® *	PRESS SEAL® SYSTEMS	
			ECONOSEAL	KWIK SEAL
12" (300mm)	1257AGHPU	410	1250	KA750
15" (375mm)	1557AGHPU	490	1530	KS750
18" (450mm)	1857AGHPU	610	18701.48500	KS800
24" (600mm)	2457AGHPU	800	24803.48500	KS800
30" (750mm)	3057AGHPU	1040	32000.48500	N/A

\* THIRD PARTY - CODES AS SUPPLIED BY MANUFACTURER  
A-LOK is a registered trademark of A-LOK Products, Inc. (www.a-lok.com)

### NOTES:

PERFORMANCE HIGHLY DEPENDENT ON INSTALLATION. CONTRACTOR MUST ENSURE MANHOLE GASKET IS UNIFORMLY SEATED AROUND STRUCTURE ADAPTER. EXTRA PRECAUTIONS MUST BE TAKEN TO PREVENT DIFFERENTIAL SETTLEMENT BETWEEN THE PIPE AND MANHOLE.

SEE STANDARD DETAIL STD-201 AND TECHNICAL NOTE: 5.04 HDPE CONNECTIONS TO MANHOLES AND STRUCTURES FOR INSTALLATION RECOMMENDATIONS.

NYLOPLAST PVC ADAPTER OD EQUIVALENT TO SDR 35

5	UPDATED DETAIL AND TABLE	AMT	09-09-19		
REV.	DESCRIPTION	BY	MM/DD/YY	CHK'D	

© 2019 ADS, INC.

ADVANCED DRAINAGE SYSTEMS, INC. ("ADS") HAS PREPARED THIS DETAIL BASED ON INFORMATION PROVIDED TO ADS. THIS DRAWING IS INTENDED TO DEPICT THE COMPONENTS AS REQUESTED. ADS HAS NOT PERFORMED ANY ENGINEERING OR DESIGN SERVICES FOR THIS PROJECT, NOR HAS ADS INDEPENDENTLY VERIFIED THE INFORMATION SUPPLIED. THE INSTALLATION DETAILS PROVIDED HEREIN ARE GENERAL RECOMMENDATIONS AND ARE NOT SPECIFIC FOR THIS PROJECT. THE DESIGN ENGINEER SHALL REVIEW THESE DETAILS PRIOR TO CONSTRUCTION. IT IS THE DESIGN ENGINEERS RESPONSIBILITY TO ENSURE THE DETAILS PROVIDED HEREIN MEETS OR EXCEEDS THE APPLICABLE NATIONAL, STATE, OR LOCAL REQUIREMENTS AND TO ENSURE THAT THE DETAILS PROVIDED HEREIN ARE ACCEPTABLE FOR THIS PROJECT.

12"-30" HP STORM COMPRESSION (CAST-IN)  
STRUCTURE CONNECTION W/ SLEEVE OR PVC ADAPTER

DRAWING NUMBER: STD-207A



ADVANCED DRAINAGE SYSTEMS, INC.

4640 TRUEMAN BLVD  
HILLIARD, OHIO 43026

DRAWN BY: CKM  
DATE: 2/23/10  
C/D BY:  
SCALE: NTS  
SHEET: 1 OF 1